

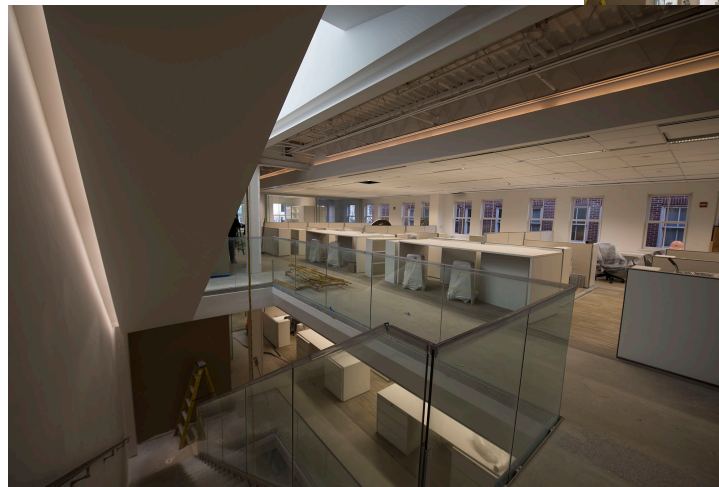

February 12, 2017

Florida Chapter Members:

Fundraising for the ASLA Center for Landscape Architecture continues to reach out to landscape architecture firms, practitioners, and corporate partners. To date the campaign has received \$1,218,001 million in cash and pledges. Staff and volunteers are continuing to pursue additional firms for their charitable support while at the same time reaching out to all individual ASLA members for their participation in the campaign.



ASLA is stepping up promotion of the ASLA Fund Heritage Circle program that recognizes members and friends who have included the Fund in their estate plans. Charitable gifts made through bequests help ensure ASLA's ability to continue promoting the values of landscape architecture in the uncertain years ahead. Promotion of the Heritage Circle will include ads in Landscape Architecture Magazine, postcards to emeritus members and emails to long-standing ASLA members.

The Executive Committee held its winter meeting at the ASLA Center for Landscape Architecture on January 27-28. Agenda items included: discussion of 2016 program results and outcomes to inform strategic planning; an update on the rebranding initiative; and a discussion with the director of the National League of Cities' Sustainable Cities Institute regarding climate change and resilience initiatives.

ASLA has joined with allied organizations in sending a letter to leaders of the Senate and House of Representatives urging them to support strong funding for conservation, recreation, and preservation programs during the fiscal year 2018 budget process.

**American Society of
Landscape Architects
Florida Chapter**

1390 Timberlane Road
Tallahassee, Florida 32312
Tel: 850-222-6000

www.flasla.org

COREY G. MATHEWS, CAE
Executive Director

**FLORIDA CHAPTER
EXECUTIVE COMMITTEE**

DAVID FLANAGAN
President
DEENA BELL LLEWELLYN
President-Elect
JONATHAN HAIGH
Past-President
JENNIFER DAOULAS
Secretary
LAURIE HALL
Treasurer
DAVID FERRIS
Trustee
ALEX FENECH
Broward
KEVIN WHITE
Jacksonville
JOSE FONSECA
Miami
LEIGH GEVELINGER
Southwest Florida
CAELI TOLAR
Gainesville
TRICIA RICHTER
Palm Beach/Treasure Coast
JOHN DELVITTO
Tampa Bay
STEVE ROBERTS
Tallahassee
EBRU OZER
Florida International University
DAN MANLEY
University of Florida
PATRICIA CASTELLANO
*Member at Large
Education and Research*
ADAM MCCOLLISTER
*Member at Large
Public Relations and Marketing*
SCOTT MOSOLF
*Member at Large
Leadership and Membership*
RICHARD KLAR
*Member at Large
Advocacy and Licensure*
CLAUDIA VISCONTI
*Member at Large
Emerging Professionals*



Numerous state legislatures are considering licensure reform legislation. State Government Affairs continues to work with chapters to respond to landscape architecture licensure threats and to provide support for positive legislative measures. Last week, ASLA provided a support letter for Alaska bill H.B. 48 which would create a permanent, voting member seat for a landscape architect on the Alaska State Board of Architects, Engineers, and Land Surveyors.

Did your chapter have a great year in advocacy in 2016? Then consider nominating your chapter or chapter leader for an advocacy award. Categories include ASLA Chapter of the Year Advocacy Award, ASLA Rising Star Advocacy Award, and the ASLA Advocacy Leadership Award. Submissions for all ASLA Advocacy Awards nominations are due no later than February 28. For questions regarding the advocacy award program, please contact Mark Cason (202-216-2370).

Once again, ASLA is offering a special JobLink summer internship promotion to its members. During the months of February, March, and April, ASLA members may post one free intern position per firm, agency, or organization. As of today, there are six intern postings.

The Landscape Architecture Continuing Education System™ (LA CES™) has 227 active providers offering 1,103 courses. There is one new provider application pending review.

The 2017 Annual Meeting Call for Presentations closed last week with 424 education and 39 field sessions received. The Annual Meeting Education Advisory Committee is reviewing submissions this month. Session notifications will be sent in March.

Best regards,
David Ferris, RLA